

Dimensions

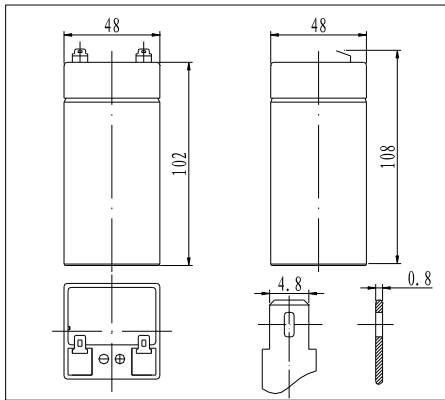

The Relationship for Open Circuit Voltage and Residual Capacity (25°C)

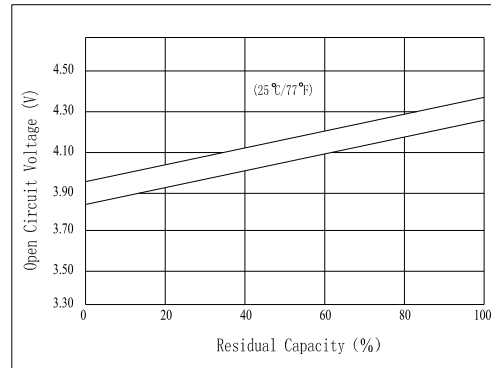

Specifications

Nominal Voltage		4 V
Capacity(20HR, 25°C)		4.5 Ah
Dimension	Length	48mm (1.89inch)
	Width	48mm (1.89inch)
	Height	102mm (4.02inch)
	Total Height	108mm (4.25inch)
Approx. Weight		0.52kg (1.15lbs)
Internal resistance (Fully charged, 25°C)		Approx. 15m Ω
Capacity affected by temperature (20HR)	40°C	102%
	25°C	100%
	0°C	85%
	-15°C	65%
Self-discharge (25°C)	3 month	Remaining Capacity: 91%
	6 month	Remaining Capacity: 82%
	12 month	Remaining Capacity: 65%
Nominal operating temperature		25°C ±3°C(77°F ±5°F)
Operating temperature range		-15°C ~50°C (5°F ~122°F)
Float charging voltage(25°C)		4.50 to 4.60V
Cyclic charging voltage(25°C)		4.85 to 4.95V
Maximum charging current		1.35A
Terminal material		Copper
Maximum discharge current		68A(5 sec.)

Charging Characteristics(25°C)

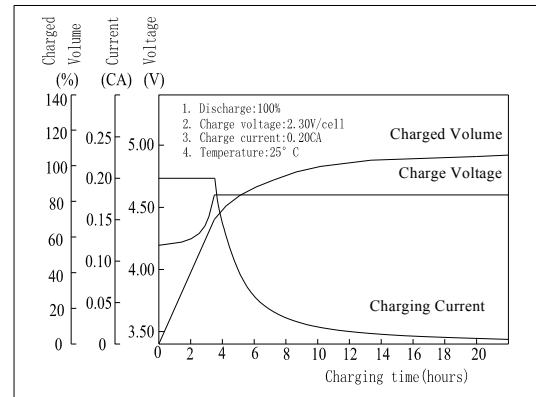

Cycle Life(25°C)

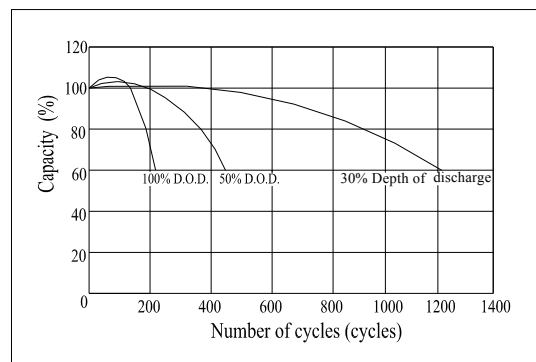

Note: Floating life at 20°C designed for 3 to 5 years.

- ◆ Absorbent glass mat technology;
- ◆ Recognized by UL & CE;
- ◆ ABS container.

Constant Current Discharge Characteristics (A, 25°C)

F.V/TIME	5min	10min	15min	30min	60min	3h	5h	10h	20h
3.20V	16.2	10.8	8.80	4.80	3.10	1.12	0.76	0.45	0.23
3.40V	15.4	10.3	8.45	4.65	3.02	1.10	0.75	0.45	0.23
3.60V	14.5	9.65	8.03	4.47	2.92	1.06	0.74	0.44	0.22

Constant Power Discharge Characteristics (Watt, 25°C)

F.V/TIME	5min	10min	15min	30min	60min	3h	5h	10h	20h
3.20V	60.3	40.6	33.4	18.3	12.0	4.44	3.02	1.80	0.92
3.40V	57.3	38.7	32.1	17.8	11.7	4.36	2.99	1.80	0.92
3.60V	53.9	36.3	30.5	17.1	11.3	4.20	2.95	1.76	0.88